

## FEATURES:

- 3.5 ~ 20 KVAC Rated Models
- Up to 0.500  $\mu$ f Capacitance
- $\pm 5 / 10\%$  Tolerance Options
- -40 to 65°C at full rated voltage  
(derate Voltage by 20% for +75°C Operation)
- Insulation Resistance of 40 - 80k  $\Omega$ F
- <0.6% Dissipation Factor @ 1,000Hz
- Tested 200% of Rated Voltage (1 min)
- Solder Lug Terminals (Standard)
- 10k hours Reliability (65°C and 100% Rated Voltage)
- ISO 9001:2015 Qualified Processes
- Tested to MIL-STD-202
- ROHS Compliance upon Request



HC capacitors are designed for very large currents of the AC or pulse type. Major applications include circuits requiring low-loss, high voltage and high current carrying capacitors: Pulse Forming Networks; Radio Frequency Bypass; Audio Frequency Bypass; Power Supply Filters; De-spiking Networks; Radio Frequency Coupling; Audio Frequency Coupling; Resonant RF and Audio Circuits; High Frequency Power Factor Correction; and Pulse Coupling Capacitors.

## CHARACTERISTICS:

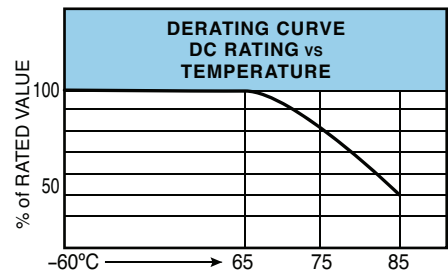
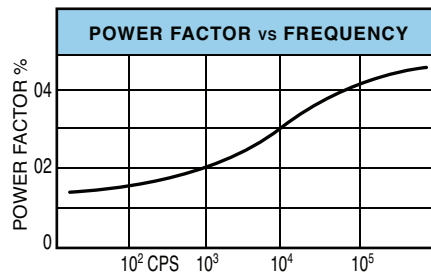
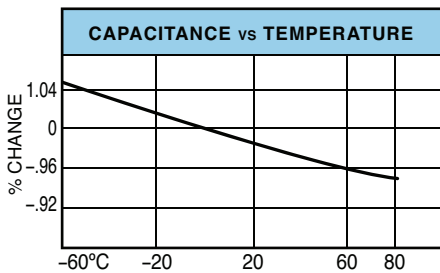

V	Model	μF	1KHz Peak Voltas	Volts Pulse	A	B	C	D	E
1,000	HC10-104	0.1	600	800	1.750	1.000	2.250	0.813	0.750
	HC10-254	0.25	600	800	1.750	1.000	2.250	1.125	0.750
	HC10-504	0.5	600	800	2.500	1.188	4.500	2.000	0.750
	HC10-105	1	600	800	3.750	1.250	4.000	2.000	0.750
	HC10-205	2	600	800	3.750	1.750	4.000	1.125	0.750
2,500	HC25-104	0.1	1200	1500	2.500	1.188	2.500	2.000	1.125
	HC25-254	0.25	1200	1500	3.750	1.250	3.250	2.000	1.125
	HC25-504	0.5	1200	1500	3.750	1.750	4.250	2.000	1.125
	HC25-105	1	1200	1500	3.750	3.188	4.250	2.000	1.125
	HC35-503	0.05	1500	2500	2.500	1.188	2.500	1.125	1.125
3,500	HC35-104	0.1	1500	2500	2.500	1.188	3.750	1.125	1.125
	HC35-254	0.25	1500	2500	3.750	1.750	5.250	2.000	1.125
	HC35-504	0.5	1500	2500	3.750	3.188	3.750	2.000	1.125
	HC50-103	0.01	2000	3500	2.500	1.188	2.500	1.125	1.125
	HC50-203	0.02	2000	3500	2.500	1.188	2.750	1.125	1.125
5,000	HC50-503	0.05	2000	3500	3.750	1.250	2.750	2.000	1.500
	HC50-104	0.1	2000	3500	3.750	1.750	3.500	2.000	1.500
	HC70-103	0.01	3000	5000	3.750	1.250	2.250	2.000	2.250
	HC70-203	0.02	3000	5000	3.750	1.750	2.250	2.000	2.250
	HC70-503	0.05	3000	5000	3.750	1.750	3.500	2.000	2.250
7,000	HC70-104	0.1	3000	5000	3.750	3.188	4.000	2.000	2.250
	HC100-103	0.01	4500	7500	3.750	1.750	2.750	2.000	2.750
	HC100-203	0.02	4500	7500	3.750	1.750	3.750	2.000	2.750
	HC100-503	0.05	4500	7500	3.750	3.188	3.750	2.000	2.750
	HC100-104	0.1	4500	7500	4.563	3.750	5.250	2.000	2.750
10,000	HC140-103	0.01	6000	10000	3.750	1.750	3.000	2.000	2.750
	HC140-203	0.02	6000	10000	3.750	3.188	3.750	2.000	2.750
	HC140-503	0.05	6000	10000	4.563	3.750	4.750	2.000	2.750
	HC140-104	0.1	6000	10000	4.563	3.750	8.500	2.000	2.750

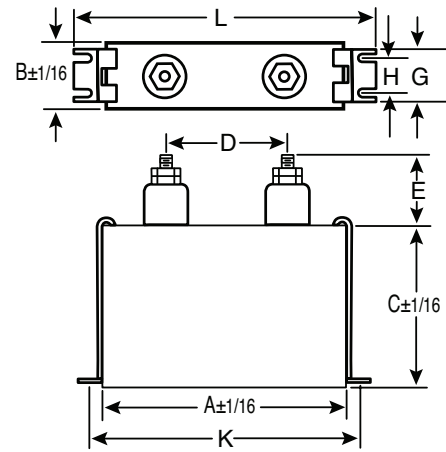

### HOW TO ORDER:

Add a “-” and a suffix to designate tolerance:

- 5 for ±5%
- 10 for ±10%